

Artwork

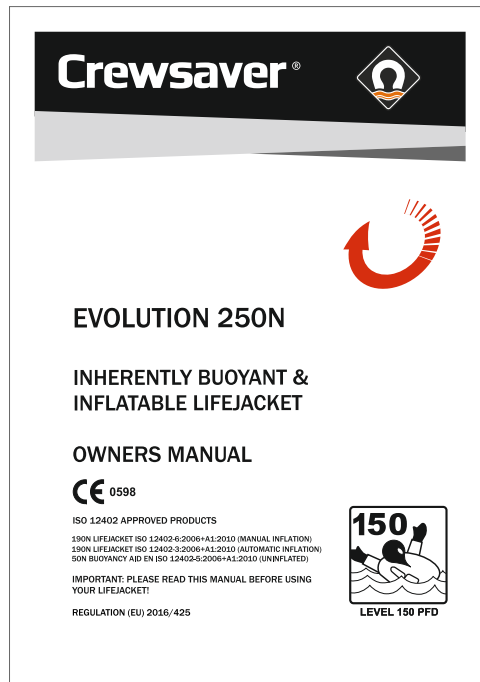

Product Description

Owner manual of Evolution 250N lifejacket. A3 double sided sheet.

Special Instructions:

Photocopied A3
 110gm white sheet.
 Full colour print.
 Matt Finish
 Finish: Double sided print, inserted into plastic pouch

Changes from Previous Issue:

Date	Specification Issue Number	PAA Reference No.	Changes to Previous Issue
25/11/2020	i6	PAA 7210 PAA 7185 PAA 7194	<ol style="list-style-type: none"> 1. Replace NB Address from FTL to : SGS FIMKO OY TAKOMOTIE 8, 00380 HELSINKI- Page 3 2. Replace NB Number next to CE mark from 0514 to 0598 - Page 3 3. Fitting instructions of EXOLOK mechanism added to user manual- Page 4 4. Whistle position modified from securing around the oral tube to stitched construction at the edge of the inflation chamber- Page 3

Authorised by:

Folding Instructions

Size: A3 sheet white paper
 Finish: Double sided print, inserted into plastic pouch

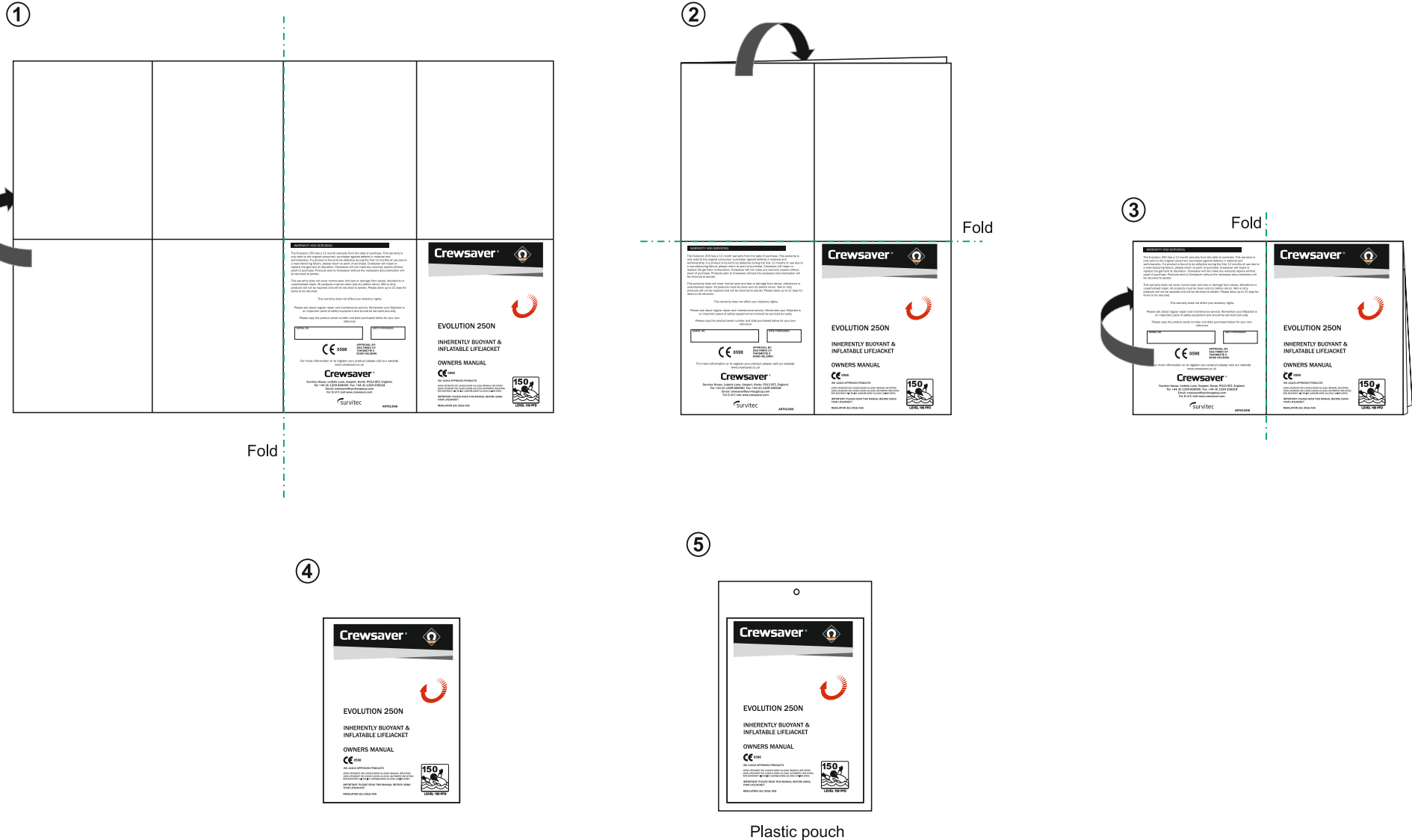

DONNING YOUR EVOLUTION 250 LIFEJACKET

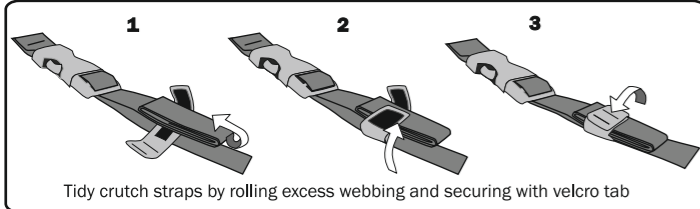
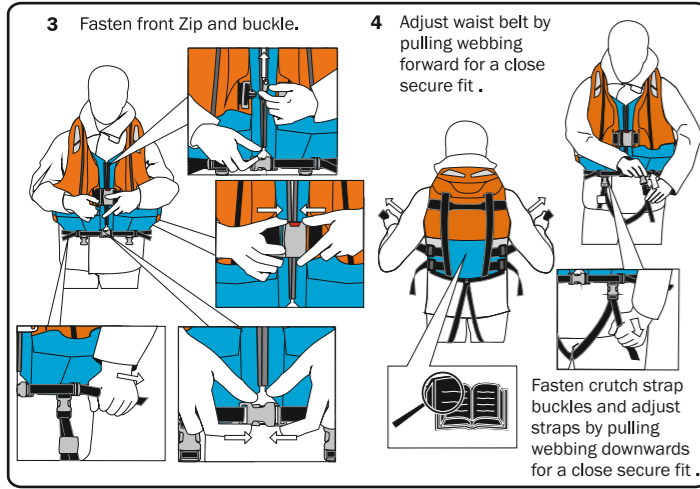
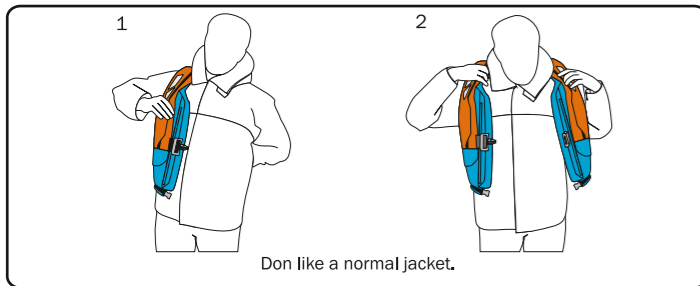

CARE AND MAINTENANCE OF YOUR LIFEJACKET

Your Lifejacket is an important item of technical safety equipment. The working life of the Lifejacket will be prolonged if the following instructions are adhered to:

BEFORE USE:

Train yourself in the use of this device! Always ensure that the Lifejacket is worn correctly. Check buckles and other fastenings regularly. Examine the Lifejacket for signs of damage, wear, tear or contamination. Pay particular attention to the webbings and the stitching on your Lifejacket. Each time you use your Evolution jacket it is important that you check it is ready to use. Check that the green manual firing indicator is present and that the pull to inflate lanyard is present. Make sure that the 38g CO₂ capsule is securely fitted. See "Re-arming your Lifejacket" Ensure that the manual pull toggles are accessible.



AFTER USE (if Inflated):

Rinse your Lifejacket after use. Refer to "Cleaning & Storing your Lifejacket" for details.

Re-arm your Lifejacket. Refer to "Re-arming your Lifejacket" section for details.

PERIODICAL CHECKS (at least every three Months):

A complete inspection of your Lifejacket is to be carried out every 3 months.

Check the fabric for cuts, tears, abrasion and signs of damage caused by heat.

Leak testing is an important part of the periodical checks. Inflate your lifejacket orally until firm. Leave overnight or for a minimum of 12 hours. A lifejacket that is leaking will not hold its firmness and must be replaced. If your lifejacket leaks please contact Crewsaver for assistance. Re-pack your lifejacket using the repacking instructions in this manual.

NOTE: Avoid wide variations in temperature when performing this test! Temperature variation can cause the inflatable chamber to loose firmness.



Perform the Oral Inflation Valve Test as follows

1. Fully inflate the Lifejacket.
2. Place the Oral tube into water and check for bubbles.
3. If bubbles appear a replacement valve is required, please Contact Crewsaver.



CLEANING & STORING YOUR LIFEJACKET

It is important that the lifejacket is stored in a dry, well ventilated space. If the lifejacket is wet or damp, and it is fitted with an automatic firing capsule, it is advisable to remove the capsule until the lifejacket is completely dry. Any dampness in the lifejacket may penetrate the capsule and eventually cause it to operate the lifejacket. It is advisable to hang the lifejacket to dry on a plastic coat hanger until it is completely dry before stowing. To avoid inflation, do not submerge the lifejacket in water unless the lifejacket has been used or the capsule has been removed. Periodically rinse the lifejacket in fresh water, particularly if it has been in contact with salt water. Oil and similar marks should be removed by washing with warm soapy water. Never put your lifejacket in a washing machine, spin or tumble dryer. After washing always allow your lifejacket to dry naturally before stowing in a dry place.



OTHER IMPORTANT INFORMATION

Your new Evolution 250 has been tested to meet a temperature range between -30°C and 65°C as required by BS EN ISO 12402.

When the temperature is well below freezing, your Lifejacket may only partially inflate. At very low temperatures a fully discharged cylinder may not adequately inflate your Lifejacket. In these temperatures the oral tube should be used for additional topping up if necessary.

Full performance may not be achieved using waterproof clothing or in other circumstances. Check before each use according to manufacturer's instructions. Do not use as a cushion.

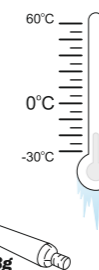

WARNING: Inflating your Lifejacket using CO₂ inflation could over pressurise and damage your Lifejacket if it has already been orally inflated fully.

WARNING: This Lifejacket is inflated by a CO₂ gas cylinder! Gas cylinders are dangerous goods, and they must be kept away from children and not misused!

WARNING: If you are not confident in self-inspection of your Lifejacket using these instructions, Contact Divisional training staff.

THREADING OF BUCKLES

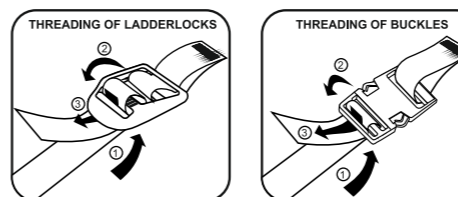

INTRODUCTION TO LIFEJACKETS

This Manual contains all you need to know about your new Evolution 250 Lifejacket.

The information contained within this manual provides the necessary details you need to don, re-arm, where and when to service and how to store your Lifejacket. Please read this Manual carefully and keep it in a safe place. It is important that you thoroughly understand your Lifejacket, its features and how to ensure it performs as intended throughout its working life.

This 60N inherently buoyant jacket remains a personal flotation device until inflated. It will not self right until inflated.

This is not a Lifejacket until fully inflated.

Practice and training is required before use.

WARNING: May not be suitable for persons with disabilities.

YOUR EVOLUTION 250 LIFEJACKET COVER FEATURES

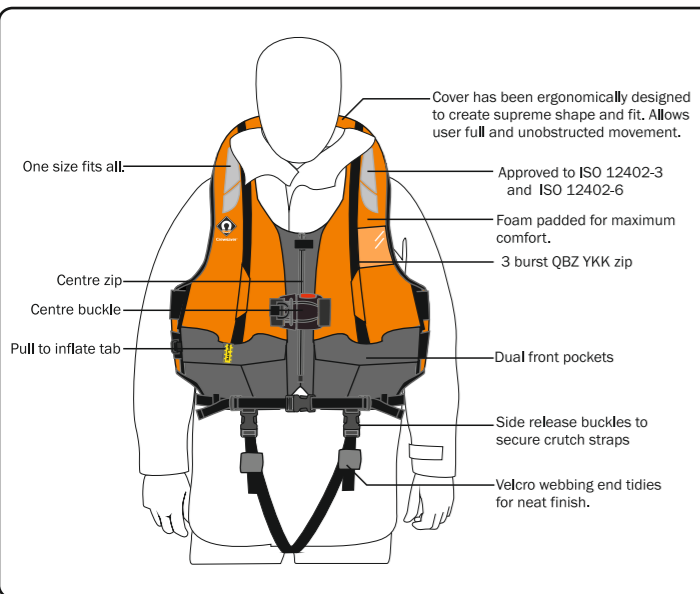

YOUR EVOLUTION 250 LIFEJACKET



THE EVOLUTION 250 INFLATION CHAMBER FEATURES:

The Evolution 250 is a Level 150 PFD is fitted with 60N inherently buoyant foam + 190 Inflation chamber with Standard Pro Sensor Elite Manual inflation or Pro Sensor Elite Automatic inflation, Quick Tri burst zip, Knife pocket, back webbing stowage pocket, Back haulage handle, Dual lifting beackets, Dual crutch straps.

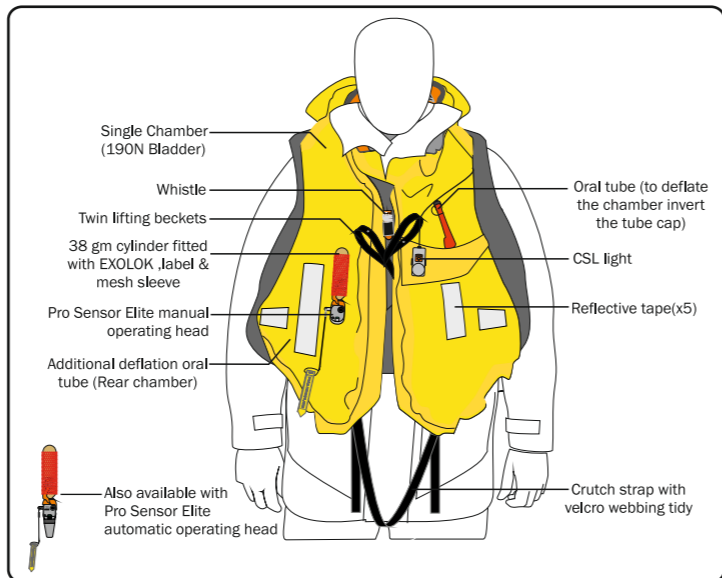

WARRANTY AND SERVICING

The Evolution 250 has a 12 month warranty from the date of purchase. This warranty is only valid to the original consumer/ purchaser against defects in material and workmanship. If a product is found to be defective during the first 12 months of use due to a manufacturing failure, please return to point of purchase. Crewsaver will repair or replace the garment at discretion. Crewsaver will not make any warranty repairs without proof of purchase. Products sent to Crewsaver without the necessary documentation will be returned to sender.

This warranty does not cover normal wear and tear or damage from abuse, alterations or unauthorised repair. All products must be clean and dry before return. Wet or dirty products will not be repaired and will be returned to sender. Please allow up to 21 days for items to be returned.

This warranty does not affect your statutory rights.

Please ask about regular repair and maintenance service. Remember your lifejacket is an important piece of safety equipment and should be serviced annually.

Please copy the product serial number and date purchased below for your own reference

SERIAL NO. [] DATE PURCHASED: []



APPROVAL BY: SGS FIMKO OY TAKOMOTIE 8 00380 HELSINKI

For more information or to register your product please visit our website www.crewsaver.co.uk



Survitec House, Lederle Lane, Gosport, Hants, PO13 0FZ, England.
Tel: +44 (0) 1329 820000 Fax: +44 (0) 1329 236218
Email: crewsaver@survitecgroup.com
For D of C visit www.crewsaver.com



ART013616

USING SPRAY HOODS WITH YOUR LIFEJACKET

If your jacket has a spray hood then you should familiarise yourself with how it works in case of an emergency

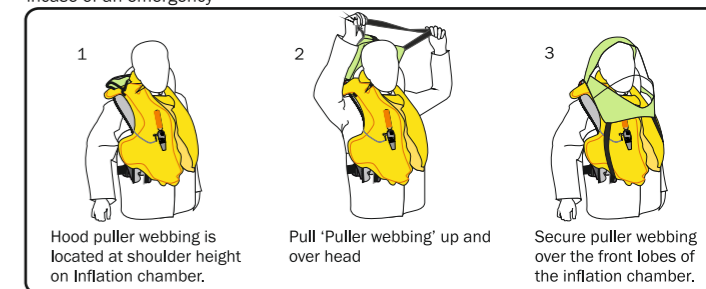

REPACKING THE SPRAYHOOD

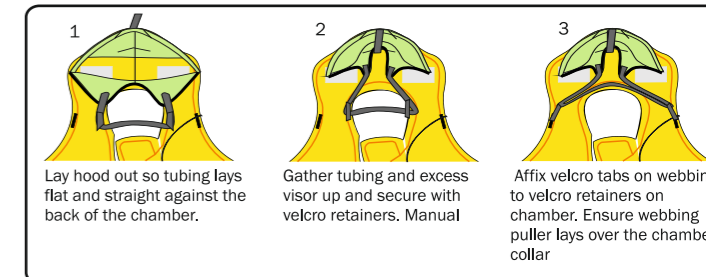

CORRECT USE OF LIFTING BECKETS

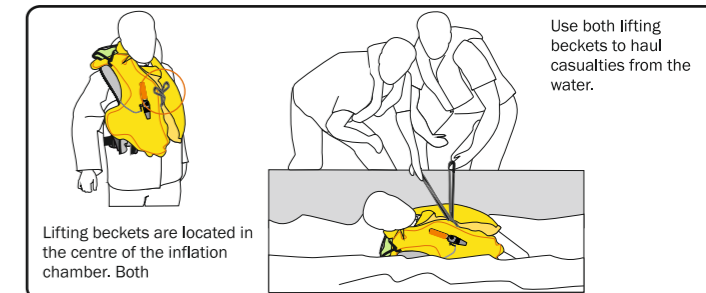

EVOLUTION 250N

INHERENTLY BUOYANT & INFLATABLE LIFEJACKET

OWNERS MANUAL



ISO 12402 APPROVED PRODUCTS

190N LIFEJACKET ISO 12402-6:2006+A1:2010 (MANUAL INFLATION)
190N LIFEJACKET ISO 12402-3:2006+A1:2010 (AUTOMATIC INFLATION)
50N BUOYANCY AID EN ISO 12402-5:2006+A1:2010 (UNINFLATED)

IMPORTANT: PLEASE READ THIS MANUAL BEFORE USING YOUR LIFEJACKET!

REGULATION (EU) 2016/425



LEVEL 150 PFD

YOUR EVOLUTION 250N LIFEJACKET

This jacket has a minimum inherent foam buoyancy of 50N and an actual foam buoyancy of 60N. Additional inflatable buoyancy of 190N can be achieved automatically or manually. Check the inflation method before use.

Un-inflated this device is a level 50 buoyancy aid, for the use in sheltered waters with help and rescue close to hand. When inflated, this device is a 150 and is intended for general application or for use with foul weather clothing. Automatic inflation will turn an unconscious person into a safe position and requires no subsequent action by the user to maintain this position.

This is a non harness jacket which can be worn over a separate harness.

Manual Gas Inflation

An inflatable buoyancy of 190N can be achieved manually. The gas cylinder can be activated by pulling the lanyard located outside the cover on the bottom right side of the jacket.

Check your inflation mechanism before use

Oral inflation

The lifejacket incorporates 1 oral inflation tube containing a non-return valve for oral topping up and to allow for deflation after use. The inflation tube located on the upper left chamber is positioned adjacent to the neck.

Optional Light

The MED approved LED light is automatically activated. Light will activate when the switch is immersed in water. If the sensor does not reach the water when inflation chamber is deployed, the sensor can be pulled from its velcro guide and placed in the water. To turn the light off pull the switch out of the water or use the manual off switch.

For full instructions please refer to the light manual

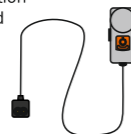

Optional spray Hood BS EN ISO 12402-8

The spray hood can be deployed once the lifejacket is inflated. The spray hood is donned by pulling the hood over the head and forward passing the webbings over the bottom of the inflation chamber.

Whistle

The life jacket is fitted with a Dual Tone - Marine approved whistle. This is located on the front right oral tube.

KNOW YOUR INFLATION MECHANISM TYPE.

PRO SENSOR ELITE: AUTOMATIC OR MANUAL

1. (AUTOMATIC ONLY) Check that the automatic firing capsule (C) is screwed fully onto the operating mechanism (B). Ensure that the capsule (C) has not been fired inadvertently by checking that the bottom indicator shows green (D). Also check the expiry date on the side of the capsule. Do not use a capsule that is out of date!

2. Check the CO₂ cylinder (A) is securely screwed into the operating mechanism with EXOLOK mechanism and label (F) and fit mesh sleeve (G). Check that the top indicator (D) shows green.

3. Ensure pull tab (E) is fixed to the velcro tab on the lower left of the cover.

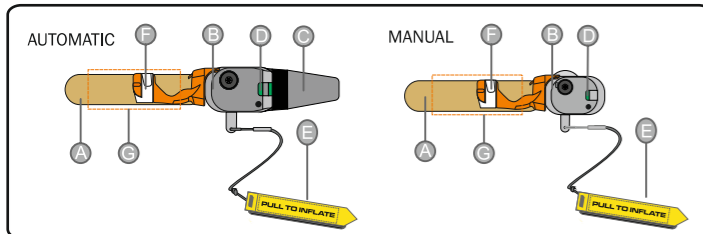

RE-ARMING PRO SENSOR ELITE OPERATING MECHANISMS

Always re-arm your lifejacket ready for use before you stow it away. The operating mechanism must be thoroughly dried before rearming. When re-arming your lifejacket it is important you use only Crewsaver supplied components. For your nearest supplier contact Crewsaver or see www.crewsaver.co.uk.

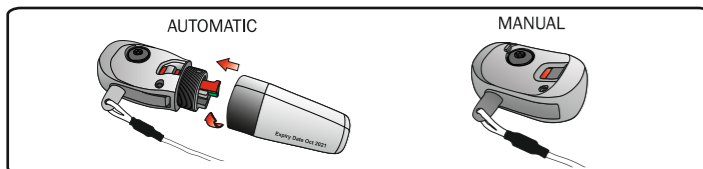

AUTOMATIC ONLY Take the new automatic firing capsule and screw onto the operating mechanism in a clockwise direction. Screw right up ensuring there is no gap between the capsule and the base of the operating mechanism. Do up hand tight. The bottom indicator will turn green when capsule is tightened correctly.

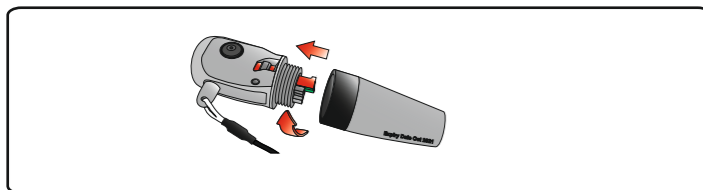

Check that the cylinder sealing gasket in the end of the operating mechanism has been correctly fitted, or replaced if necessary. Check the new CO₂ cylinder has not been used. Fit EXOLOK mechanism (A) and screw cylinder into the main body in a clockwise direction (B). Ensure the cylinder is screwed right down and hand tighten. The top indicator will turn green when the cylinder is tightened correctly. Secure with EXOLOK label (C) then fit mesh sleeve.

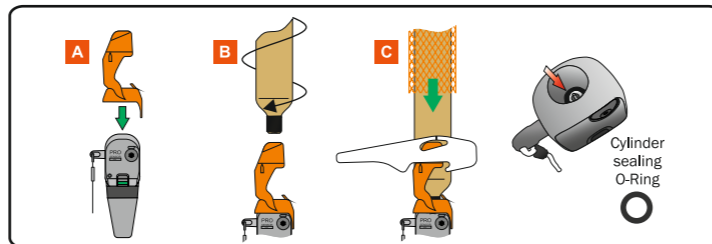

WARNING
Warning: If you are unsure or have any doubt how to re-arm and repack your lifejacket return the product to Crewsaver or your nearest Crewsaver service agent. See www.uml.co.uk for more details on the UML Pro-Sensor Elite mechanism.

USING THE INFLATION TUBE ON INFLATABLE LIFEJACKETS

If required all inflatable Lifejackets can be inflated orally without firing the CO₂ cylinder.

The Evolution inflation chamber is fitted with none return valves.

INFLATING YOUR LIFEJACKET:

1. Remove the valve cap (a) at the top of the inflation tube (b).
2. Blow into the inflation tube. The protective cover on the Lifejacket will unfold as the inflation chamber takes shape. To make this easier open up the cover by hand and continue to blow into the tube until it is difficult to inflate further.
3. Ensure once inflated that you replace the valve cap (a). It is important to keep this in place, except when the deflation valve is being used.



DEFLATING YOUR LIFEJACKET AFTER USE:

This jacket is fitted with two oral tubes. One on each side of the inflation chamber to ease deflation when repacking.

1. Reverse the valve cap (a) at the top of the inflation tube and hold it in the valve.

WARNING: DO NOT use anything other than the valve cap to deflate your Lifejacket! Any other item used may cause damage to the valve, and could cause your lifejacket to deflate.

2. Squeeze the Lifejacket to expel as much gas as possible.

WARNING: If the lifejacket has been inflated using a gas cylinder take care not to inhale the expelled CO₂ gas.

3. The Lifejacket should now be completely deflated, and can be folded into the cover.
4. Replace the valve cap (a) back into the normal position on top of the Inflation tube.



WARNING: Over inflation can damage your Lifejacket.

UNPACKING THE EVOLUTION 250

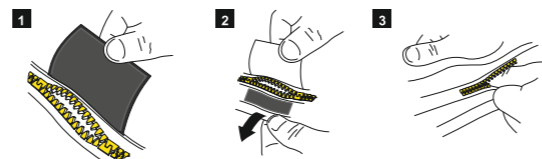

OPENING THE LIFEJACKET COVER

1. Open the velcro tab.
2. Pull apart the zip, opening the zip via the 3 quick burst elements, holding the cover either side.
3. Once the zip has opened insert your finger and slide it around the Lifejacket. Undo the zip all the way around the outside of the lifejacket. The Lifejacket cover should now be open and the inflation chamber visible. Fully separate the zip. Both sides of the zip should be apart, with the zip slider free to return to the start.

PREPARING ZIP FOR REPACKING

4. Ensure that the zip slider is separated on one side of the zip.
5. Slide the zip around to the correct end of the Lifejacket.
6. Feed the zip teeth into the slider ready to re pack.
7. When closing zip when re packed, pull zip slider right down to the yellow marker teeth.

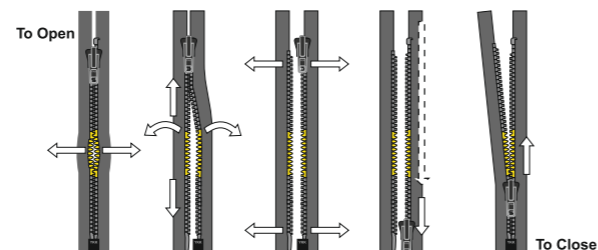

REPACKING THE EVOLUTION 250 LIFEJACKET

Ensure that your Lifejacket is dry before packing.

Note: These instructions include a light and automatic inflation mechanism. If fitted with a spray hood refer to "re-packing the spray hood". Use the same packing instructions for Manual inflation jackets.

<p>1</p> <p>Fix light activator to its elastic retainer at the back of the collar. For details about the light please see www.crewsaver.co.uk</p>	<p>2</p> <p>Ensure the lifting buckets are secured to press studs on front of the inflation chamber.</p>	<p>3</p> <p>Tuck chin support inside itself so there is a straight line from corner to corner.</p>
<p>4</p> <p>Fold the bottom right edge of the chamber up as far as it will go.</p>	<p>5</p> <p>Fold outer edge over towards the center as far as it will go.</p>	<p>6</p> <p>Concertina inner edge over and tuck everything inside cover and close cover using zip from the right side.</p>
<p>7</p> <p>Fold Chamber collar down as far as it will go.</p>	<p>8</p> <p>Fold the top edge back to make a concertina.</p>	<p>9</p> <p>Fold top corners of collar down. Tuck collar into cover and continue to run the zip round to close. Take care not to tangle light cord.</p>
<p>10</p> <p>Concertina bottom left side of Chamber. Ensure capsule lays on top of the fabric.</p>	<p>11</p> <p>Fold outer left side of Chamber over towards the center. Being careful not to tangle the pull cord.</p>	<p>12</p> <p>Fold the inner edge of the Chamber over towards the outside. If excess air is inside the chamber, use the additional oral tube on the left to release.</p>
<p>13</p> <p>Fold the inner edge of the Chamber over again so that the inflation mechanism is visible on top. Close the zip.</p>	<p>14</p> <p>Tuck zip ends inside cover so the bottom of the jacket looks neat. Ensure velcro tabs are fixed in place.</p>	<p>15</p> <p>Fix velcro puller tab to the lower left of the cover.</p>